

REVISION NO.	SYMBOL	DESCRIPTION	SHT./OF	DATE	APPROVED
STATE OF HAWAII DEPARTMENT OF LAND AND NATURAL RESOURCES DIVISION OF BOATING AND OCEAN RECREATION					
NORTH KAWAIIHAE SMALL BOAT HARBOR INFRASTRUCTURE IMPROVEMENTS					
DETAIL SHEET					
DESIGNED: GT		SUBMITTED:			
DRAWN: GT		DATE: MAY 2020			
CHECKED: CT		SCALE: 1:XX			
APPROVED:		DATE:		DRAWING NO. C-7	
ADMINISTRATOR		DATE:			

LINE	IBEGIN	EBEGIN	LINE	LENGTH	BEARING	LINE	IBEGIN	EBEGIN	LINE	LENGTH	BEARING
L1	52.37	487394	2	135.32	114° 52'	L41	213.69	214.04	1	3.35	178° 52'
L2	171.60	247802	22	4.21	185° 47'	L42	6.00	6.41	1	4.41	178° 52'
L3	164.62	467551	23	33.60	129° 58'	L43	11.7	13.14	1	13.94	178° 52'
L4	174.62	183252	24	63.60	100° 00'	L44	10.00	10.99	1	10.99	178° 52'
L5	174.62	183252	25	8.42	131° 00'	L45	10.00	10.99	1	10.99	178° 52'
L6	8.42	183252	26	29.59	185° 00'	L46	11.0	12.10	1	11.10	178° 52'
L7	9.00	2125443	27	73.57	185° 00'	L47	11.0	12.10	1	11.10	178° 52'
L8	12.11	181813	28	9.01	181° 00'	L48	11.0	12.10	1	11.10	178° 52'
L9	0.75	2125443	29	52.22	185° 00'	L49	11.0	12.10	1	11.10	178° 52'
L10	2.50	1252446	30	13.59	113° 56'	L50	11.0	12.10	1	11.10	178° 52'
L11	45.87	118121	31	6.01	181° 00'	L51	11.0	12.10	1	11.10	178° 52'
L12	1.61	1221900	32	19.27	181° 56'	L52	11.0	12.10	1	11.10	178° 52'
L13	4.22	118121	33	62.62	185° 00'	L53	11.0	12.10	1	11.10	178° 52'
L14	4.66	118121	34	14.62	185° 00'	L54	11.0	12.10	1	11.10	178° 52'
L15	1.90	1825242	35	63.67	181° 00'	L55	11.0	12.10	1	11.10	178° 52'
L16	1.82	1825242	36	44.62	181° 00'	L56	11.0	12.10	1	11.10	178° 52'
L17	2.51	1825242	37	73.4	181° 00'	L57	11.0	12.10	1	11.10	178° 52'
L18	1.82	1848180	38	6.97	181° 00'	L58	11.0	12.10	1	11.10	178° 52'
L19	4.20	180911	39	17.4	184° 00'	L59	11.0	12.10	1	11.10	178° 52'
L20	1.82	181813	40	23.9	181° 00'	L60	11.0	12.10	1	11.10	178° 52'

CHORD	LENGTH	RADIUS	BEARING	TANGENT
C1	574	100	154° 02'	212
C2	124	630	141° 00'	113
C3	142	100	119° 00'	136
C4	124	100	119° 00'	115
C5	171	100	149° 02'	134
C6	124	630	141° 00'	113
C7	124	100	119° 00'	136
C8	150	100	138° 02'	131
C9	147	100	112° 00'	131
C10	124	630	141° 00'	113
C11	124	100	119° 00'	136
C12	124	100	119° 00'	136
C13	124	100	119° 00'	136
C14	124	100	119° 00'	136
C15	124	100	119° 00'	136
C16	124	100	119° 00'	136
C17	124	100	119° 00'	136
C18	124	100	119° 00'	136
C19	124	100	119° 00'	136
C20	124	100	119° 00'	136

CHORD	LENGTH	RADIUS	DELTA	TANGENT
D1	9.36	500	102° 24'	221
D2	11.22	1000	144° 00'	181
D3	8.40	1000	142° 00'	113
D4	11.31	1000	102° 00'	181
D5	7.30	500	82° 58'	124
D6	11.31	1000	144° 00'	181
D7	7.30	500	102° 00'	124
D8	11.31	1000	144° 00'	181
D9	11.31	1000	144° 00'	181
D10	11.31	1000	144° 00'	181
D11	11.31	1000	144° 00'	181
D12	11.31	1000	144° 00'	181
D13	11.31	1000	144° 00'	181
D14	11.31	1000	144° 00'	181
D15	11.31	1000	144° 00'	181
D16	11.31	1000	144° 00'	181
D17	11.31	1000	144° 00'	181
D18	11.31	1000	144° 00'	181
D19	11.31	1000	144° 00'	181
D20	11.31	1000	144° 00'	181

NOTES

- TOPOGRAPHIC SURVEY CONDUCTED BY ENGINEERS SURVEYORS HAWAII, INC. ON AUGUST 10, 2017.
- LOCATION OF ALL UNDERGROUND UTILITY LINES AND APPURTENANCES SHOWN ON THE PLANS, INCLUDING WATER LINES, POWER, AND SEWER ARE SCHEMATIC AND HAVE NOT BEEN FIELD VERIFIED. EXACT LOCATION AND CONFIGURATION OF EXISTING UTILITIES NEED TO BE VERIFIED PRIOR TO CONSTRUCTION.
- AZIMUTH AND COORDINATES REFER TO HAWAII STATE PLANE NAD 83.
- ELEVATIONS REFER TO BENCH MARK DISK STAMPED "1 RESET 1967" TOP OF BRASS DISK ELEVATION = 8.37 FEET (MEAN LOWER LOW LEVEL).
- BOUNDARIES SHOWN GRAPHICALLY IN RELATION TO BRASS DISK FOUND.

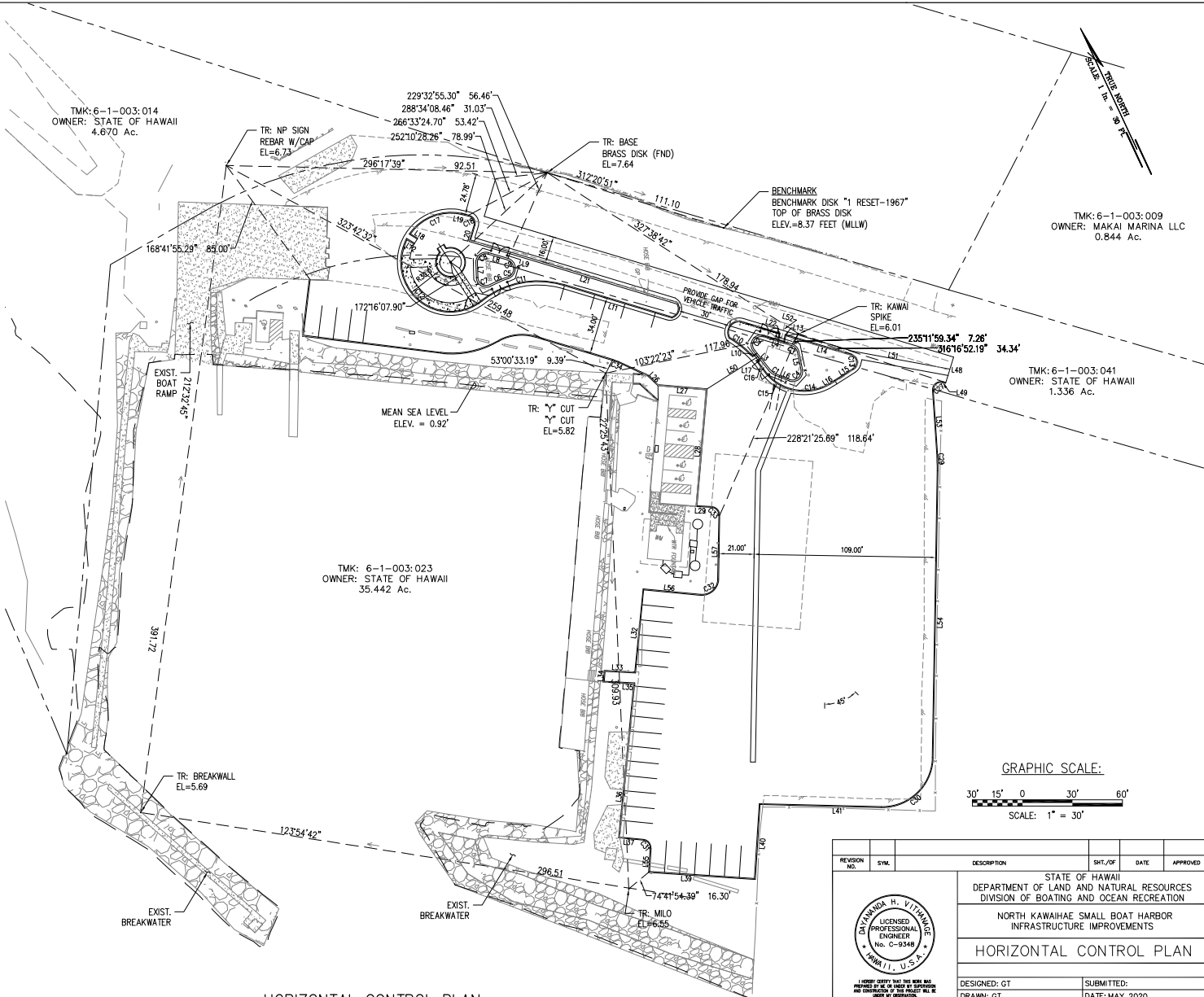

HORIZONTAL CONTROL PLAN
SCALE: 1" = 30'-0"

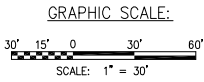

REVISION NO.	SYM.	DESCRIPTION	SHT./OF	DATE	APPROVED
STATE OF HAWAII DEPARTMENT OF LAND AND NATURAL RESOURCES DIVISION OF BOATING AND OCEAN RECREATION					
NORTH KAWAIIHAE SMALL BOAT HARBOR INFRASTRUCTURE IMPROVEMENTS					
HORIZONTAL CONTROL PLAN					
DESIGNED: GT			SUBMITTED:		
DRAWN: GT			DATE: MAY 2020		
CHECKED: CT			SCALE: 1"=30'		
APPROVED:			DRAWING NO.		
ADMINISTRATOR			C-12		